

WHITEFORD AGRICULTURAL SCHOOL DISTRICT ZERO MILL NET INCREASE BOND PROPOSALS ESTIMATED FROM THE CURRENT LEVY



Dear Whiteford Community Members,

Our school district is the heart of our community, shaping the future for our children and ensuring that every student has access to the best possible education and facilities. With the failure of the August 6, 2024 Capital Bond Proposals, we surveyed and sought feedback from community stakeholders to understand what adjustments needed to be made for the May 6, 2025 election. From this feedback, a greater focus was made for elementary school improvements and only addressing essential athletic facility needs. On Tuesday, May 6, 2025, Whiteford Schools will have two (2) proposals for a Capital Bond Project that would provide funding to enhance our elementary school facilities and athletic fields—two critical areas that impact student learning, safety, and overall well-being.

PROPOSAL 1 - WHITEFORD ELEMENTARY SCHOOL

- ✓ \$6.5 Million
- ✓ Add 5 Classrooms
- ✓ Add 3 Single Stall Bathrooms
- ✓ Add Flex Space, Single Stall Bathroom, Storage
- ✓ Replace Roof
- ✓ Replace Rooftop Air Handlers

WHY DO WE NEED FIVE (5) CLASSROOMS?

Our current KG-5th grade classroom sizes are between 22-28 students per class. We want to lower class sizes by splitting each grade-level into three classroom sections to achieve 20-22 students per classroom. Once this is achieved, we will need additional classroom space as shown in the diagram to the upper and middle right.

DOES MORE CLASSROOMS MEAN MORE STUDENTS?

We are controlling our enrollment with regards to the number of school of choice (SOC) students we accept. As an example, let's say we have 56 students that are enrolled in Kindergarten that are district residents, children of an employee, or a SOC sibling as they all get preference for enrollment. We would look to add 4 new SOC students to get our total student count to 60. We would then have 20 students in each of three classrooms. If we didn't accept the 4 SOC students, then we would have two classrooms with 28 students in each classroom.

WHY DO WE NEED A FLEX SPACE?

The elementary school would utilize this larger space for physical education classes, indoor recess, building-wide assemblies, lunch overflow, Whiteford Parent Association events (i.e. Santa's Workshop, Dances, Fundraisers, etc.), and Whiteford Recreation Club (WRC) could use the space for practices or other events. The bottom right diagram represents students using the space for physical education or indoor recess.

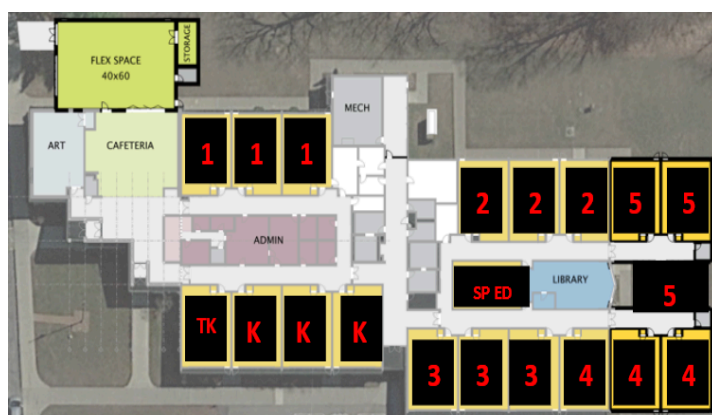
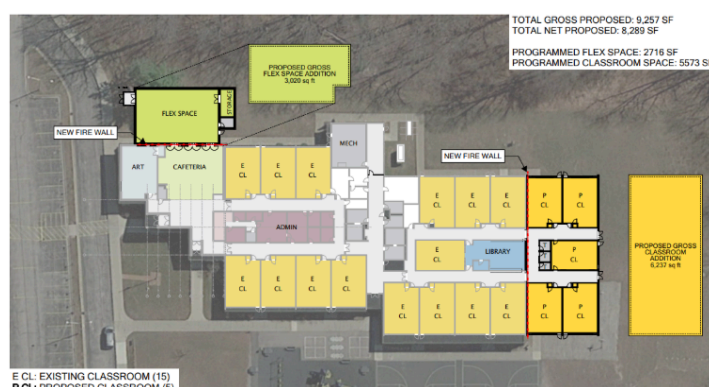

PROPOSAL 2 - WHITEFORD ATHLETICS

- ✓ \$1 Million
- ✓ Softball Field, Baseball Field, Main Entrance Work
- ✓ Replace Backstops, Dugouts, Bleachers, Press Box
- ✓ Replace Drainage Tile (Baseball Outfield)
- ✓ Add Asphalt Drive/Walkway and Concrete Paths

WHY DO WE NEED ATHLETIC IMPROVEMENTS?

We have aging structures that are made of wood that are deteriorating, and we have the opportunity to replace these structures with cinder block and metal. The backstop fencing is rusting and is deformed from the aging process. Specific to the baseball field, we need to replace and add drainage tiles to fix an on-going water issue. With regards to the current athletic main entrance and walking paths to softball, baseball, track, and football fields, it is a dirt and stone path. This project would create an asphalt drive leading to the track and football fields. Concrete paths will then connect softball and baseball to the asphalt drive making our athletic complex handicap accessible for all. The above picture shows a representation of softball, while the bottom picture shows baseball.



PROPOSAL 1 & 2 - MORE INFORMATION

We encourage all residents to learn more about the bond proposals by visiting the school district website at: <https://www.whiteford.k12.mi.us/our-district/bond-projects/>. Please contact Superintendent Huard at 734-856-1443 Ext. 101 or scott.huard@whiteford.k12.mi.us for questions or clarifications regarding the Capital Bond Campaign.

Paid for by Whiteford Agricultural Schools, 6655 Consear Rd., Ottawa Lake, MI 49267



Whiteford Agricultural Schools
6655 Consear Road
Ottawa Lake, MI 49267

CAR-RT PRESORT
BULK RATE
U.S. POSTAGE PAID
Nonprofit Org.
Permit #7

POSTAL CUSTOMER
Whiteford School District
Ottawa Lake, MI 49267